

G. GIOANOLA



DOMUS

MODELS:

DBRF/13 – DBRC/13

DBRF/20 – DBRC/20

DBRF/25 – DBRC/25

DBRF/30 – DBRC/30

DBRF/40 – DBRC/40



- * Single-jet turbine water meter
- * DBRF model for cold water up to 30 °C
- * DBRC model for hot water up to 90 °C
- * May be installed in any position
- * B/H approval: class B, horizontal
- * A/V approval: class A, vertical
- * Direct-read roller indicator
- * For clear and translucent water
- * Indelible wet dial
- * Hydraulic features in line with EEC standards following provision n°75/33

DOMUS

Nominal size of the meter			13	20	25	30	40
Qmax	Maximum flow rate	m ³ /h	3	5	7	10	20
Qn	Nominal continuous flow rate	m ³ /h	1,5	2,5	3,5	5	10
Qt	Transitional flow rate with ± 2% error	l/h	120	200	280	400	800
Qmin	Minimum flow rate with ± 5% error	l/h	30	50	70	100	200
Qt	Transitional flow rate with ± 2% error in class C	l/h	22,5	37,5	52,5	75	150
Qmin	Minimum flow rate with ± 5% error in class C	l/h	15	25	35	50	100
	Starting flow	l/h	5	8	13	13	18
	Dial registers from/to	m ³	0,0001/100.000	0,0001/100.000	0,0001/100.000	0,0001/100.000	0,0001/100.000
	Working pressure	bar	16	16	16	16	16
	Test pressure	bar	25	25	25	25	25
	Lenght 'A' without pipe fittings	mm	110	130	160	160	200
	Lenght 'B' with pipe fittings	mm	190	228	260	280	340
	Maximum diameter 'C'	mm	75	75	100	100	110
	Height 'D' with open lid	mm	147	147	185	185	200
	Height 'E' with closed lid	mm	84	84	103	103	120
	Height of tube 'F'	mm	24	24	34	34	42
	Weight including pipe fittings	kg	0,840	1,035	1,750	2,000	3,460
	Weight without pipe fittings	kg	0,680	0,780	1,280	1,330	2,420

MODELS:

FOR COLD WATER UP TO 30 °C

DBRF/13 1/2"

DBRF/20 3/4"

DBRF/25 1"

DBRF/30 1.1/4"

DBRF/40 1.1/2"

The Complete DBRF range is EEC homologated according to metrological classes B and C of EEC standards

FOR HOT WATER UP TO 90 °C

DBRC/13 1/2"

DBRC/20 3/4"

DBRC/25 1"

DBRC/30 1.1/4"

DBRC/40 1.1/2"

The Company's policy is one of continuous product improvement and the right is reserved to modify the specifications contained herein without notice

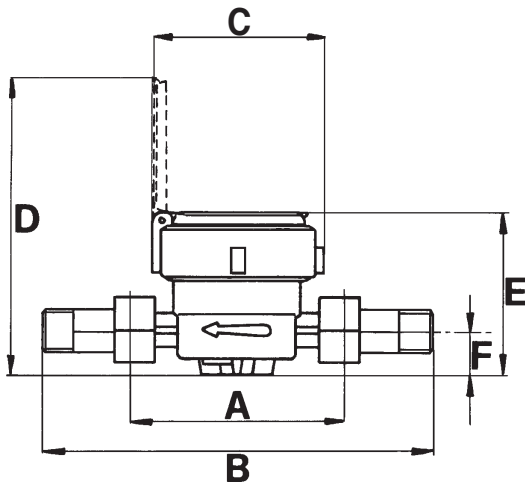

TYPICAL ACCURACY CURVE

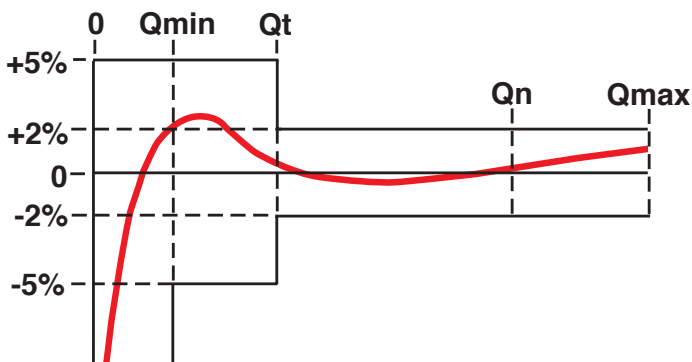

G. GIOANOLA
SISMA WATER METERS

Strada Alessandria 50
Tel. +(39)-0141-793536 - Fax +(39)-0141-702757
14049 NIZZA MONFERRATO (AT) - ITALY

E-mail: info@gioanola.it
http://www.gioanola.it

HEAD LOSS DIAGRAM

